



City of Elko Clerk's Department
1751 College Avenue
Elko, NV 89801
(775) 777-7126
FAX (775) 777-7129

**CITY OF ELKO
WATER MAIN REMOVAL AND
REPLACEMENT PROJECT
ADDENDUM NO. 1
FEBRUARY 1, 2018**

Please confirm receipt of ADDENDUM NUMBER ONE AND FAX BACK TO (775) 777-7129 or email to cityclerk@elkocity.nv.gov.

RECEIVED:

SIGNATURE

COMPANY NAME

Dated this 5th day of February, 2018.

Elko City Clerk

Shanell Owen, MMC

***** PLEASE NOTE RECEIPT OF ADDENDUM NUMBER ONE ON
APPLICABLE LINE ON SUBMITTED BID PROPOSAL *****

ADDENDUM NUMBER ONE
to the
**WATER MAIN REMOVAL AND
REPLACEMENT PROJECT
BID DOCUMENTS, SPECIFICATION AND
PLANS**

To all prospective bidders under the specifications for the **Water Main Removal and Replacement Project**, for which bids are to be received by the City of Elko, at the office of the Elko City Clerk located at 1751 College Avenue, Elko, Nevada 89801, until 3:00 P.M., local time, on Tuesday, February 13th, 2018.

The following changes, deletions and additions are herein made and become a part of the Project Bidding Documents, Specifications and Plans for the above referenced Project.

- 1) Questions regarding this project must be submitted in writing to the Shanell Owen, City of Elko, City Clerk by 3:00 P.M., local time, Tuesday, February 6, 2018. The questions will be addressed in addendum no later than 5:00 P.M., local time, Wednesday, February 7, 2018.
- 2) Please see the attached revised Sheet 4 of 6 of the Project Construction Drawings, 11th Street to 12th Street. This sheet shall replace the Sheet 4 of the original Construction Drawings. The revised sheet changes the size of the new water main from 2" diameter polyethylene pipe to 6" diameter P.V.C. pipe, and changes the fittings needed to make the connection to the existing lines at each end of the alley.
- 3) The water line will be moved 10' away from the sewer line as per plan sheet 2 of 6. This should eliminate any special crossings in this area.
- 4) The Engineer's Estimate for this project is \$217,713.
- 5) Traffic Control will be the responsibility of the Contractor. The City of Elko Water Department must approve the Traffic Control Plan.
- 6) The Contractor shall obtain a Street Cut Permit for each project location. There will be no fee assessed for the permit.
- 7) Compaction testing will be provided by the City. Any retesting due to failed tests will be the responsibility of the Contractor.
- 8) All new mains must be pressure tested, bacteria tested, flushed and approved by Nevada Division of Environmental Protection before being placed in service.
- 9) Any construction staking needed for the project will be provided by the City of Elko.
- 10) Any curb, gutter and sidewalk removed during water main installation will be replaced to match the existing, adjacent concrete. These area do not need to meet ADA requirements.

- 11) The City will notify affected Utility customers, Ambulance Service, and the Fire Department with a Two Day (48 Hour) Notice. The Contractor shall notify Elko Sanitation with a Five Day Notice.
- 12) There will be no new meter pits installed with this project.
- 13) At points of connection to existing valves, the existing valve box shall be reused. If a valve box is unserviceable and needs to be replaced, a new valve box will be provided by the City.
- 14) OSHA 10 and 30 cards are required for this project.
- 15) City crews will be available to assist with faulty curb stops and repairs.
- 16) It is unknown if ground water could be a problem.
- 17) It is unknown who marked 11th and 12th Street but it was not the Water Dept.
- 18) Current water line materials are;
 - Court St. is galvanized and is estimated to be over 50 years old.
 - Wilson St. is polyethylene
 - 3rd and 4th Streets are polyethylene
 - 11th and 12th streets are polyethylene
- 19) PWP Requirements- Not required unless the bid goes over the \$250,000.00 requirement.
- 20) Follow the Bid Evaluation Check list closely.
- 21) Be certain to pay close attention to pg. 44-45. Contractors must self-list on both.
- 22) Contractor's State License- A copy is required from the CSLB- Do a print out, and do not forget to include a copy from the SOS (Secretary of the State) we need to see dates clearly.
- 23) The project needs to be completed by June 30, 2018.

4.0 EXHIBITS

EXHIBIT 1 - BID FORM

THIS FORM, FULLY COMPLETED, MUST BE USED FOR ALL BIDS

TO THE CITY OF ELKO, NEVADA:

The undersigned bidder hereby offers, in the amount stated in Exhibit 1 – Bid Form, to furnish all labor, materials, tools, equipment, apparatus, facilities, transportation, incidental items and permits (except as otherwise stated in the Contract Documents) for the construction of the Project, described as follows:

THE CITY OF ELKO WATER MAIN REMOVAL AND REPLACEMENT PROJECT

The bidder agrees that the work will be performed in accordance with the Contract Documents together with incidental items necessary to complete the work to be constructed in accordance with the Contract, any and all Exhibits to the Contract, Exhibit 16 – Technical Specifications, Exhibit 8 – Project Construction Plans and also in accordance with the *"Standard Specifications and Details for Public Works Construction"*, 2016 Revised Edition, and amendments (Orange Book) as adopted by the City of Elko, Nevada.

| Item No. & Work Description | Quantity | Unit | Unit Price | Bid Amount |
|--|-----------------|-------------|-------------------|-------------------|
| 1) Mobilization/Demobilization | 1 | L.S. | | |
| 2) 6" Dia. P.V.C. Water Main | 1670 | L.F. | | |
| 3) 2" Dia. Polyethylene Water Main | 6 | L.F. | | |
| 4) 18" x 6" Tapping Tee & Valve | 1 | EA. | | |
| 5) 12" x 6" Tapping Tee & Valve | 1 | EA. | | |
| 6) 8" x 6" Tapping Tee & Valve | 1 | EA. | | |
| 7) 6" Tapping Tee & Valve | 1 | EA. | | |
| 8) 6" x 2" Reducer | 4 | EA. | | |
| 9) 2" – 90° Bend | 2 | EA. | | |
| 10) 6" – 45° Bend | 4 | EA. | | |
| 11) 6" x 2" Tee | 1 | EA. | | |

| | | | | |
|-------------------------------|-----|------|--|--|
| 12) 2" Tee | 1 | EA. | | |
| 13) 2" Gate Valve | 2 | EA. | | |
| 14) 6" Gate Valve | 1 | EA. | | |
| 15) Connect Existing Services | 27 | EA. | | |
| 16) Replace P.C.C. Sidewalk | 390 | S.F. | | |
| 17) Replace Curb & Gutter | 70 | L.F. | | |
| 18) Pavement Patch | 460 | S.F. | | |
| 19) Traffic Control | 1 | L.S. | | |

TOTAL BASE BID AMOUNT (BID ITEMS NO. 1 – NO. 19) IN NUMBERS =

\$ _____

TOTAL BASE BID AMOUNT (BID ITEMS NO. 1 – NO. 19) IN WRITTEN FORM =

BASE BID INSTRUCTIONS: The Base Bid amount is to be stated in legible figures only and is the total amount bid for the entire contract work, including all applicable taxes. Any alteration, erasure or change must be clearly indicated and initialed by the bidder. The bidder agrees that the following, without limitation, may, in the City's discretion, constitute grounds for rejecting this bid as non-responsive: (1) one or more blanks are not filled in; (2) the bid form is not signed by an authorized representative of the bidder; (3) any words or figures are not legible; (4) there are discrepancies in the figures (to include arithmetical errors); (5) the bid is not submitted with a compliant bid bond; (6) the bidder supplies false information on this bid form; or (7) the bidder fails to provide information required by this bid form or Nevada law.

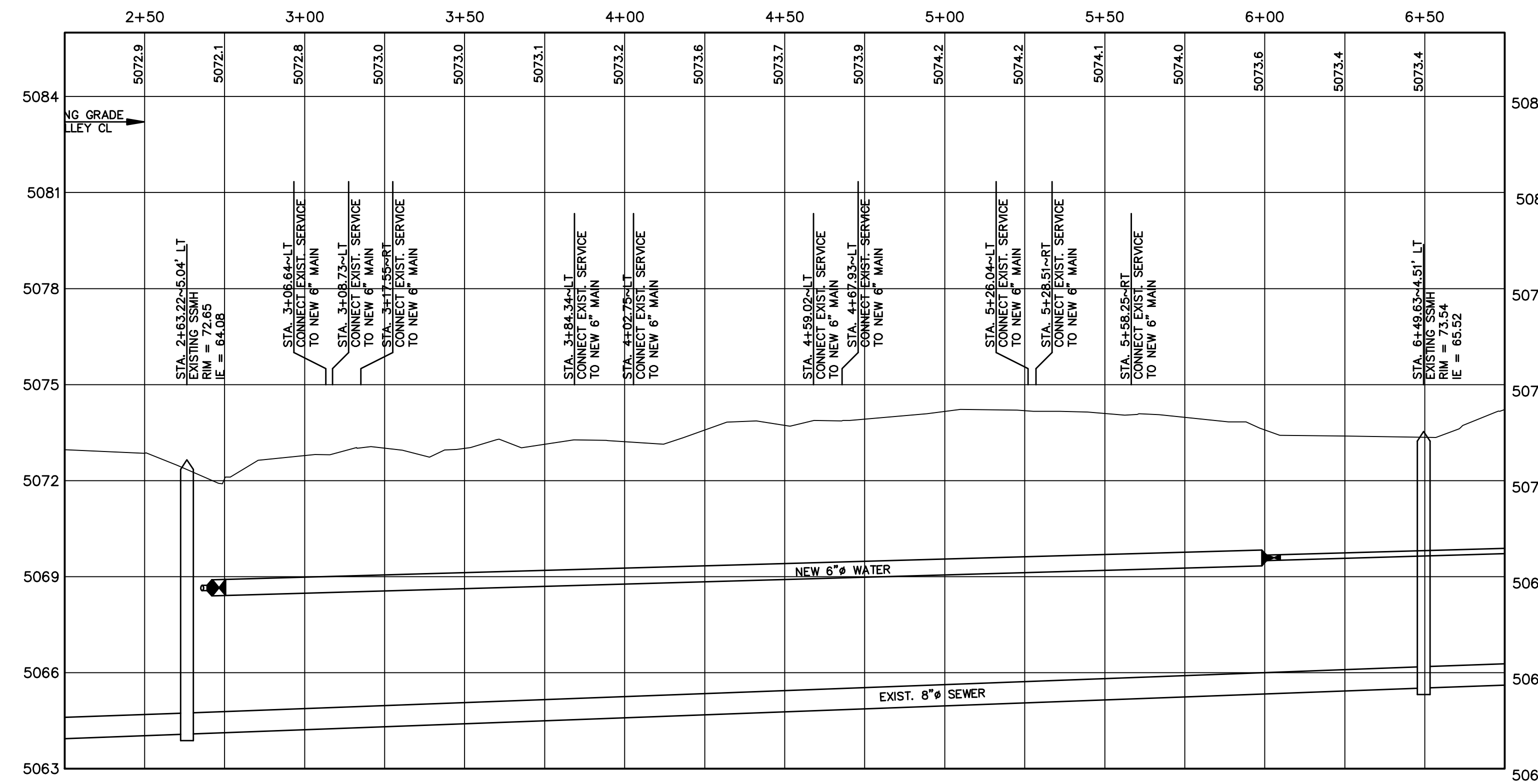
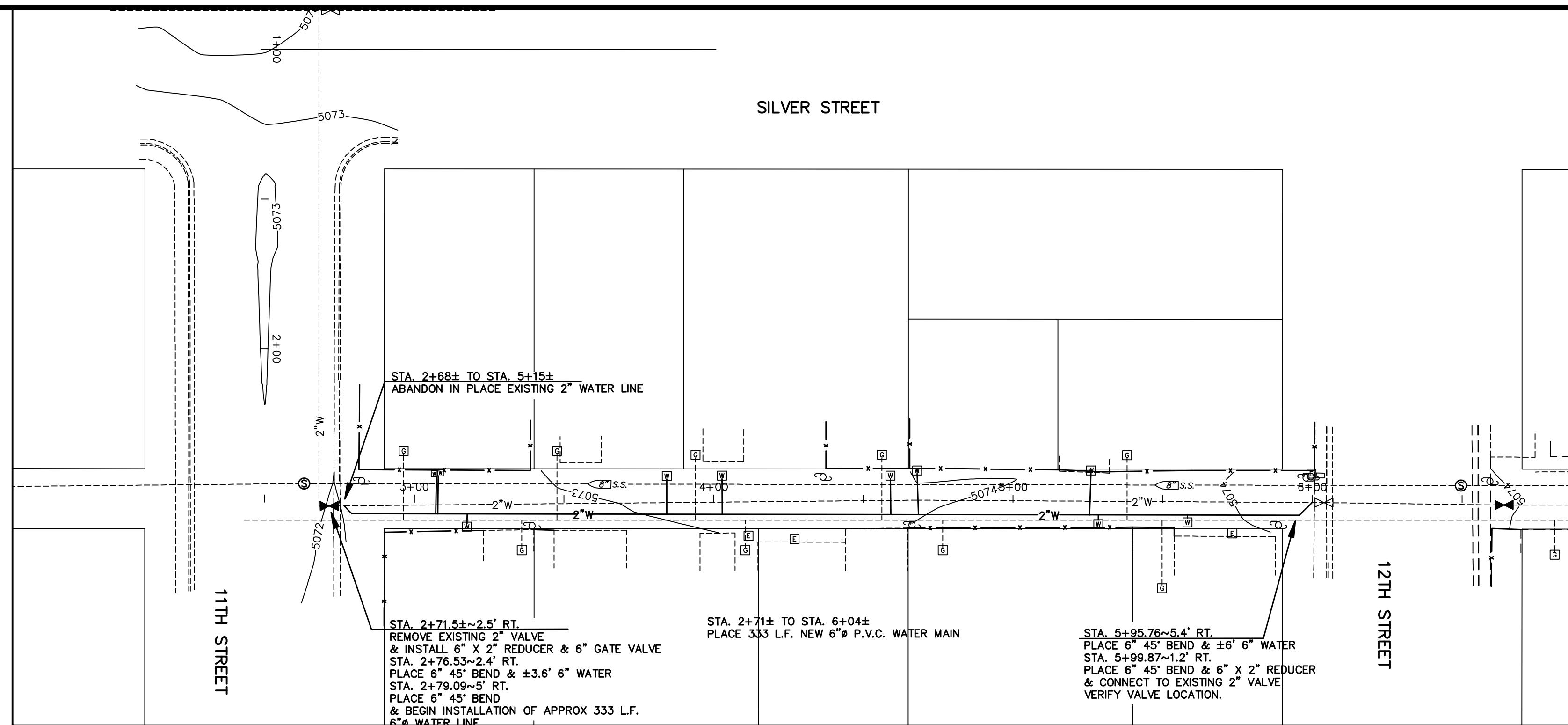

LEGEND

| | |
|-------------|--|
| — PA — | PROPERTY LINE |
| ☆ | EXISTING LIGHT POLE |
| — 8" S.S. — | EXIST. SEWER WITH SIZE & DIRECTION INDICATED |
| — 6" W — | EXISTING WATER LINE W/ SIZE INDICATED |
| --- | EXISTING OVERHEAD POWER |
| P | SANITARY SEWER CLEANOUT |
| --- | EXISTING GAS LINE |
| 99 | EXISTING GROUND CONTOUR |
| ⊙ | EXISTING UTILITY POLE |
| ⊠ | ELECTRICAL BOX |
| ⊡ | TELEPHONE PEDESTAL |
| ⊡ | TELEVISION PEDESTAL OR BOX |
| ⊡ | GAS SERVICE |
| ⊡ | WATER SERVICE |

TWO DAYS BEFORE YOU DIG
 CALL USA TOLL FREE
1-800-227-2600

GENERAL UTILITY NOTES

- THE CITY OF ELKO UTILITY DEPARTMENT SHALL BE CONTACTED FOR AUTHORIZATION TO PLACE ANY NEW WATER SYSTEMS, EXTENSIONS, REPLACEMENTS IN EXISTING SYSTEMS AND VALVED SECTIONS INTO SERVICE FOR TESTING OR FINAL ACCEPTANCE.
- BEFORE BEING CERTIFIED BY AN ENGINEER OR ACCEPTED BY THE CITY OF ELKO, ANY NEW WATER SYSTEMS, EXTENSIONS, REPLACEMENTS IN EXISTING SYSTEMS AND VALVED SECTIONS SHALL BE DISINFECTED IN ACCORDANCE WITH AWWA C-651, "DISINFECTING WATER MAINS". TWO SETS OF CONSECUTIVE SAMPLES ARE REQUIRED AT LEAST 24 HOURS APART FROM EVERY 1200 FEET OF MAIN.
- BEFORE BEING CERTIFIED BY AN ENGINEER OR ACCEPTED BY THE CITY OF ELKO, ANY NEW WATER SYSTEMS, EXTENSIONS, REPLACEMENTS IN EXISTING SYSTEMS AND VALVED SECTIONS SHALL BE PRESSURE TESTED IN ACCORDANCE WITH NAC 445A.67145 (7).
- AT ALL POINTS WHERE SEWER (SANITARY OR STORM), WATER MAINS AND LATERALS CROSS, VERTICAL AND HORIZONTAL SEPARATION SHALL BE MAINTAINED PER NAC. ENGINEER AND CONTRACTOR TO REFERENCE SECTION 445A.6715 TO SECTION 445A.6718 OF THE NEVADA ADMINISTRATIVE CODE FOR UTILITY SEPARATION AND CLEARANCES.
- ALL CONSTRUCTION TO BE AWWA C-600 OR AWWA C-605 COMPLIANT AS APPROPRIATE.
- WATER TAPS ONTO THE WATER MAIN ARE TO BE A MINIMUM OF SIX FEET FROM HYDRANT TAPS
- ALL WATER SERVICE LINES SHALL BE 1" IRON PIPE SIZE (IPS) RATED 200 PSI POLYETHYLENE (AWWA C-901), UNLESS OTHERWISE SHOWN.
- ALL OPENINGS IN UNFINISHED PIPING OR APPURTENANCES MUST BE SEALED AT THE END OF EACH WORKING DAY IN SUCH A MANNER AS TO PREVENT THE ENTRY OF BIRDS AND OTHER ANIMALS, DIRT, TRENCH WATER AND OTHER SOURCES OF POLLUTION OF CONTAMINATION.
- THE MATERIALS SPECIFIED FOR THE WATER SYSTEM SHALL MEET THE REQUIREMENTS OF NAC 445A.66085 "LEAD FREE" AND NAC 445A.67125 "DISTRIBUTION SYSTEMS: MATERIALS".
- PVC WATER MAINS (12" & SMALLER) SHALL BE PRESSURE CLASS 235 PVC (AWWA C-900).
- 2" WATER MAINS SHALL BE 200 PSI SDR-11 POLYETHYLENE PIPE (AWWA C-901).
- ALL WATER MAINS SHALL BE INSTALLED WITH LOCATER WIRE AND MARKING TAPE.
- WATER MAIN FITTINGS SHALL BE DUCTILE IRON, W/ 8 MIL POLYETHYLENE WRAP.
- WATER MAINS AND SERVICE LINES TO BE PLACED WITH 42" MINIMUM COVER.
- WATER SERVICE LINES TO BE 200 PSI POLYETHYLENE, IN ACCORDANCE WITH CITY OF ELKO SPECIFICATIONS.
- REFERENCE DETAIL SHEETS FOR TYPICAL SECTIONS, CONSTRUCTION DETAILS AND ADDITIONAL SPECIFICATIONS.
- ALL CONNECTIONS TO THE EXISTING WATER MAINS WILL BE DONE BY THE CITY OF ELKO. THE CONTRACTOR SHALL COORDINATE THIS WORK WITH THE CITY OF ELKO.
- WATER TAPS ONTO THE WATER MAIN ARE TO BE IN ACCORDANCE WITH CITY OF ELKO STANDARD DETAIL U-12.1.
- ALL WATER MAINS, HYDRANTS, WATER AND SEWER SERVICE CONNECTIONS REQUIRE CITY OF ELKO INSPECTIONS PRIOR TO BACKFILLING.
- THE CONTRACTOR SHALL NOTIFY UNDERGROUND SERVICE ALERT (1-800-227-2600) AT LEAST 48 HOURS PRIOR TO BEGINNING EXCAVATION OR GRADING OPERATIONS. THE CONTRACTOR SHALL BE RESPONSIBLE FOR ANY DAMAGE TO EXISTING UTILITIES ENCOUNTERED DURING CONSTRUCTION.
- HORIZONTAL AND VERTICAL LOCATIONS OF EXISTING UTILITIES ARE APPROXIMATE ONLY. THE CONTRACTOR SHALL INFORM HIMSELF OF THE EXACT LOCATION OF ALL EXISTING UTILITIES AND IMPROVEMENTS. ANY DAMAGE TO EXISTING UTILITIES OR IMPROVEMENTS CAUSED BY THE OPERATION OF THE SHALL BE REPAIRED BY THE CONTRACTOR AT HIS OWN EXPENSE.
- ALL EXISTING WATER SERVICES TO BE CONNECTED TO NEW WATER MAINS. SIZE TO MATCH EXISTING OR BE 1" MINIMUM. CITY OF ELKO WATER DEPARTMENT WILL LOCATE OR VERIFY ALL EXISTING SERVICE CONNECTION LOCATIONS.

UTILITY NOTES

- ALL HOT TAPS TO BE DONE BY CITY OF ELKO WATER DEPARTMENT.
- CONTRACTOR TO PROVIDE TRAFFIC CONTROL FOR ALL WORK IN THE CITY STREETS AND RIGHTS OF WAY.
- ADVANCE NOTIFICATION SHALL BE GIVEN TO WATER USERS PRIOR TO SHUTTING OFF WATER SERVICE. NOTIFICATIONS SHALL INCLUDE DATE OF SERVICE INTERRUPTION, APPROXIMATE TIME WATER WILL BE SHUT OFF AND TIME WATER SERVICE WILL BE RESTORED.
- EXISTING WATER SERVICES SHALL BE PROTECTED AND MAINTAINED DURING INSTALLATION OF NEW MAIN. FOLLOWING INSTALLATION OF NEW MAIN ALL EXISTING SERVICES SHALL BE CONNECTED TO NEW MAIN PRIOR TO ABANDONMENT OF EXISTING MAIN. INTERRUPTION OF WATER SERVICE TO EXISTING SERVICES SHALL BE KEPT TO A MINIMUM. ALL INTERRUPTIONS TO WATER SERVICE SHALL BE RESTORED PRIOR TO THE END OF SAME WORKING DAY IN WHICH IT WAS INTERRUPTED.
- ADVANCE NOTIFICATION SHALL BE GIVEN TO WATER USERS PRIOR TO SHUTTING OFF WATER SERVICE. NOTIFICATIONS SHALL INCLUDE DATE OF SERVICE INTERRUPTION, APPROXIMATE TIME WATER WILL BE SHUT OFF AND TIME WATER SERVICE WILL BE RESTORED.
- EXISTING ASPHALT CONCRETE PAVEMENT WITHIN TRENCH EXCAVATION SHALL BE REMOVED AND DISPOSED OF. DISTURBED AREAS SHALL BE SURFACED WITH COMPACTED TYPE 2 AGGREGATE BASE. REPAVING WILL NOT BE REQUIRED.
- AT ALL LOCATIONS WHERE THE EXISTING 2" WATER MAIN IS IN THE SAME LOCATION AS THE PROPOSED NEW WATER MAIN, THE EXISTING MAIN SHALL BE REMOVED AND PROPERLY DISPOSED OF, IF THE NEW MAIN CAN BE INSTALLED WITHOUT INTERFERENCE FROM THE EXISTING MAIN IT CAN BE ABANDONED IN PLACE.
- NEW WATER MAIN SHALL BE A MINIMUM DISTANCE OF 10' FROM EXISTING SEWER MAINS.
- REFER TO SHEET 6, DETAIL SHEET, FOR ALL CONSTRUCTION DETAILS.

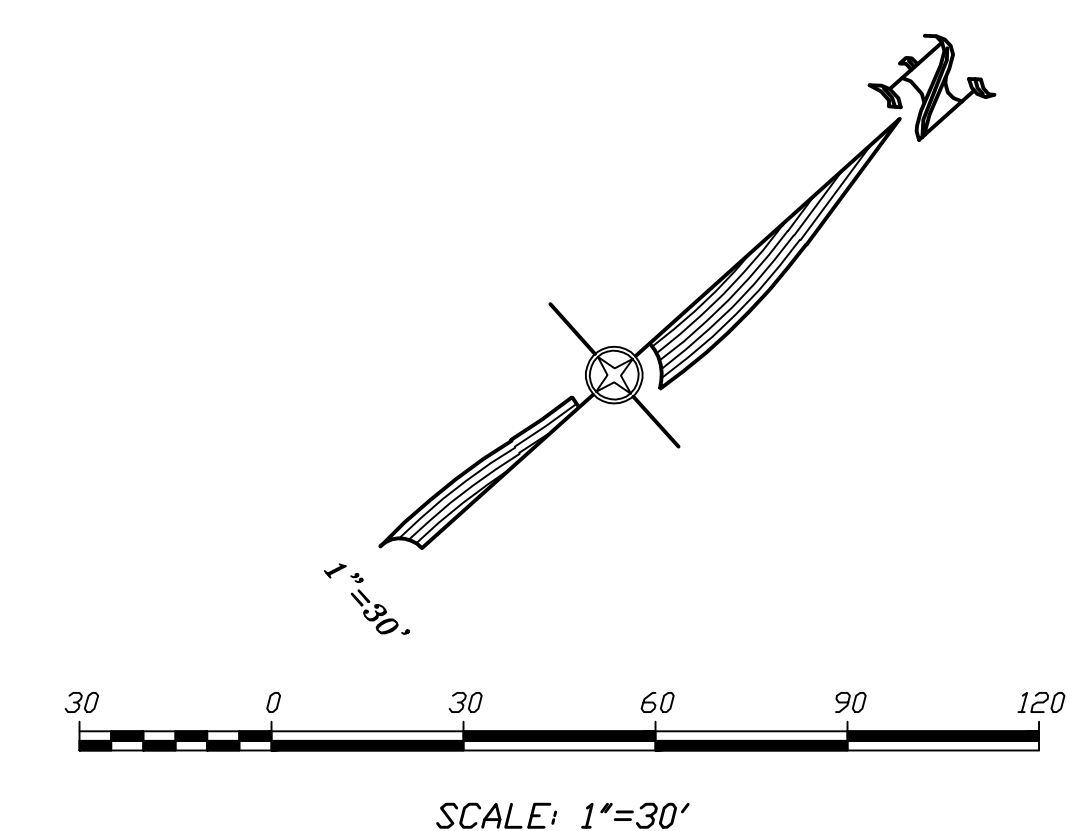

| | | | | | |
|--|--------------------|-----------------------|--|-----------------|--|
| | | | | | |
| BY | APP'D | | | | |
| DATE | DESCRIPTION | | | | |
| 1 | REV. CITY REVIEW | | | | |
| 2 | REV. DEP. REVIEW | | | | |
| 3 | ISSUED FOR BIDDING | | | | |
| 4 | CHANGE MAIN TO 8" | | | | |
| DESIGNED BY: FMP | | DRAWN BY: FMP | | CHECKED BY: FMP | |
| APPROVED BY: FMP | | DATE: SEPTEMBER, 2017 | | | |
| CITY OF ELKO WATER MAIN REMOVAL & REPLACEMENT 11th STREET TO 12th STREET ELKO COUNTY NEVADA | | | | | |
| SCALE: 1" = 30' HORIZ. 1" = 30' VERT. 1" = 30' JOB No. 6510 DWG. No. 217047 | | | | | |
| CONSULTING ENGINEERING & SURVEYING HIGH DESERT ENGINEERING 640 IDAHO STREET ELKO, NEVADA 89601 (775) 738-4053 | | | | | |
| SHEET 4 OF 6 | | | | | |