

# CITY OF ELKO

## 6TH ST. STORM DRAIN REPAIR

**OWNER/DEVELOPER:**

**CITY OF ELKO**  
**ATTN: MR. DENNIS STRICKLAND**  
**1751 COLLEGE AVE.**  
**ELKO, NV 89801**  
**PH.: (775) 777-7241**  
**FAX: (775) 774-7249**

**ENGINEERS**

  
**1751 COLLEGE AVE.**  
**ELKO, NV 89801**  
**PH.: (775) 777-7110**  
**FAX: (775) 774-7119**

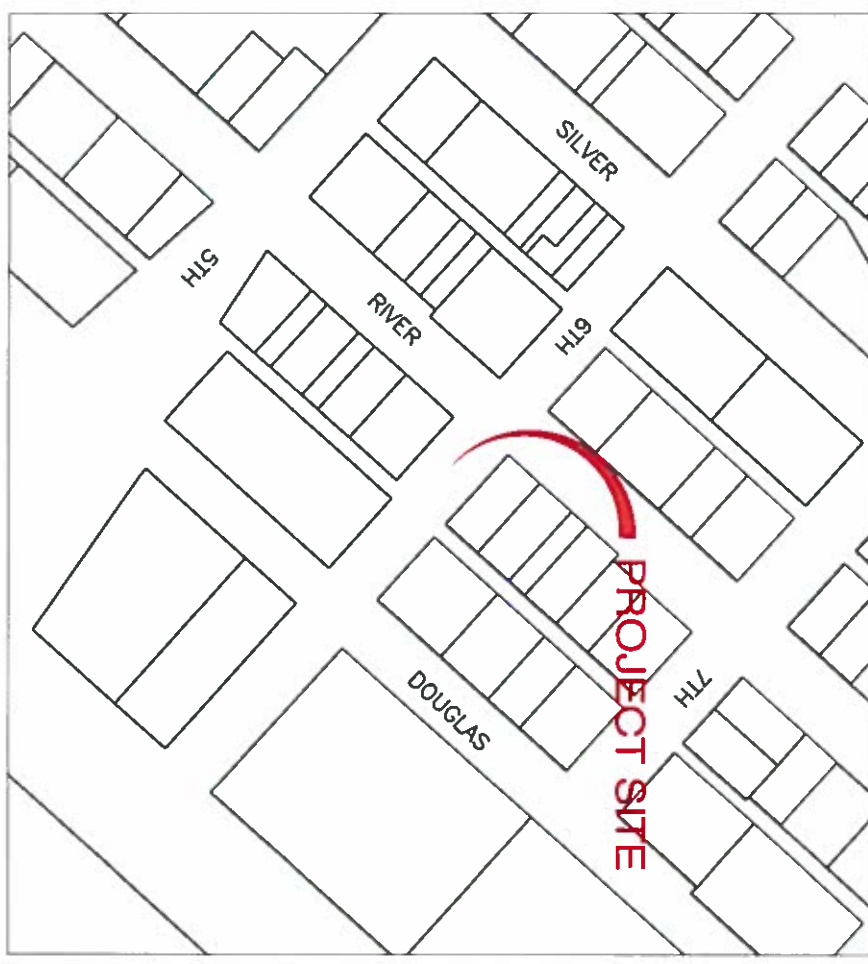

**VICINITY MAP**

2 working  
 days  
**Call before you Dig.**

**1-800-227-2600**

AVOID CUTTING  
 UNDERGROUND UTILITIES

**SHEET INDEX:**

- TITLE SHEET \_\_\_\_\_ 1
- SITE PLAN & PROFILE \_\_\_\_\_ 2
- DETAIL SHEET \_\_\_\_\_ 3

**GENERAL NOTES:**

1. THE CONTRACTOR SHALL MAINTAIN A 24-HOUR DUST CONTROL PROGRAM INCLUDING WATERING OF OPEN AREAS. DUST CONTROL PROGRAM SHALL BE IN COMPLIANCE WITH ALL FEDERAL, STATE, COUNTY AND CITY CODES AND ORDINANCES.
2. THE CONTRACTOR SHALL MAINTAIN AN ONGOING PROCESS FOR REMOVAL OF SPILLAGE OF EXCAVATED MATERIAL ON ALL PAVED STREETS.
3. ALL CONSTRUCTION SHALL MEET THE REQUIREMENTS OF THE LATEST EDITION OF THE STANDARD SPECIFICATIONS & DETAILS FOR PUBLIC WORKS CONSTRUCTION--ORANGE BOOK-- AS PUBLISHED BY THE WASHOE COUNTY RTC.
4. ALL AREAS DISTURBED AND LEFT UNDEVELOPED FOR A PERIOD OF MORE THAN 30 DAYS SHALL BE STABILIZED BY THE APPLICATION OF A DUST PALLIATIVE. ALL AREAS LEFT UNDEVELOPED FOR A PERIOD OF MORE THAN 90 DAYS SHALL BE HYDRO-SEEDED WITH AN APPROVED SEED MIX AND TACKLER AND SHALL BE IRRIGATED UNTIL FIRMLY ESTABLISHED AS APPROVED BY THE CITY OF ELKO.
5. THE CONTRACTOR SHALL VERIFY IN THE FIELD, ALL ELEVATIONS, DIMENSIONS, FLOW LINES, EXISTING CONDITIONS, AND POINTS OF CONNECTIONS WITH ADJOINING PROPERTY (PUBLIC OR PRIVATE). ANY DISCREPANCIES SHALL BE CALLED TO THE ATTENTION OF THE PROJECT ENGINEER BEFORE PROCEEDING WITH THE WORK.
6. THE CONTRACTOR SHALL NOTIFY THE PROJECT ENGINEER, THE SOILS ENGINEER, THE CITY OF ELKO, AND ALL UTILITY COMPANIES 48 HOURS PRIOR TO COMMENCEMENT OF WORK.
7. THE CONTRACTOR SHALL CALL UNDERGROUND SERVICES ALERT AT 1,800,227,2600 AT LEAST 48 HOURS PRIOR TO EXCAVATION.
8. THE CONTRACTOR SHALL BE RESPONSIBLE FOR ANY AND ALL DAMAGE TO THE EXISTING UTILITIES ENCOUNTERED DURING CONSTRUCTION. IT SHALL BE THE CONTRACTOR'S RESPONSIBILITY TO CONTACT THE UTILITY COMPANIES FOR LOCATIONS PRIOR TO CONSTRUCTION. HORIZONTAL AND VERTICAL LOCATIONS OF EXISTING UTILITIES ARE APPROXIMATE ONLY.
9. CONTRACTOR TO OBTAIN A STREET CUT PERMIT FROM THE PUBLIC WORKS DEPARTMENT AND PAY ANY APPLICABLE FEES TO THE CITY OF ELKO PRIOR TO EXCAVATING WITHIN THE CITY RIGHT OF WAY.
10. AT ALL POINTS WHERE SEWER (SANITARY OR STORM), WATER MAINS AND LATERALS CROSS, VERTICAL AND HORIZONTAL SEPARATION SHALL BE MAINTAINED PER NAC ENGINEER AND CONTRACTOR TO REFERENCE SECTION 445A.6715 TO SECTION 445A.6718 OF THE NEVADA ADMINISTRATIVE CODE FOR UTILITY SEPARATION AND CLEARANCES.
11. A TRAFFIC CONTROL PLAN SHALL BE PROVIDED BY THE CONTRACTOR AND APPROVED BY THE CITY OF ELKO PRIOR TO CONSTRUCTION.
12. ALL CONCRETE PLACED IN THE CITY OF ELKO RIGHT OF WAY SHALL COMPLY WITH THE LATEST EDITION OF THE ORANGE BOOK AND SHALL BE A CITY APPROVED MIX DESIGN.

**BASIS OF BEARING:**

NORTH AMERICAN DATUM OF 1983/2007 PER THE NATIONAL GEODETIC SURVEY'S (NGS) PUBLISHED COORDINATES FOR NGS STATION "FUZZY", A STANDARD BRONZE DISK STAMPED "FUZZY 1957" SET IN THE TOP OF A ROUND CONCRETE POST WHICH PROJECTS 2 INCHES ABOVE THE GROUND, OF LATITUDE 40° 54' 25.01325"N, LONGITUDE 115° 41' 47.52810"W AND NEVADA STATE PLANE COORDINATE SYSTEM EAST ZONE GRID COORDINATES OF 28,488,522.75N, 624,878.27E. GROUND COORDINATES ARE USED HEREIN AND REFLECT GRID COORDINATES MULTIPLIED BY THE CITY OF ELKO ACCEPTED COMBINED GRID TO GROUND SCALE FACTOR OF 1.000357 WITH THE RESULTING GROUND COORDINATES FOR NGS "FUZZY" BEING 28,498,693.15N, 625,101.35E.

**BASIS OF ELEVATION:**

NORTH AMERICAN VERTICAL DATUM OF 1988, PER THE NATIONAL GEODETIC SURVEY'S (NGS) PUBLISHED ELEVATION FOR NGS BENCHMARK B 52, A STABILITY CLASS A MARK STAMPED "B 52 1934" SET VERTICALLY IN THE NORTHWEST WALL OF THE ELKO MAIN POST OFFICE (BRICK WITH STONE CORNERS), 0.9 FOOT SOUTHWEST OF THE NORTH CORNER, AND 4 FEET ABOVE THE GROUND.



CITY OF ELKO  
 1751 COLLEGE AVE  
 ELKO, NEVADA 89801  
 775-777-7210

**SCALE**

HORZ \_\_\_\_\_ NONE  
 VERT \_\_\_\_\_ NONE

DESIGNED BY JJ

DRAWN BY ACAD 2017

CHECKED BY BT

DATE 8/8/2017

CITY OF ELKO  
 6TH ST. STORM DRAIN REPAIR  
 TITLE SHEET

SHEET 1  
 OF 3

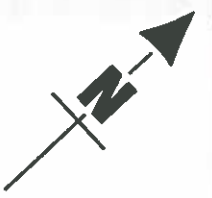

- NOTES:
- 1) ASPHALT REPAIR WILL BE DONE BY THE CITY OF ELKO.
  - 2) SAWCUTTING OF ASPHALT IS NOT REQUIRED.
  - 3) 72" CMP WILL BE PROVIDED BY THE CITY OF ELKO.

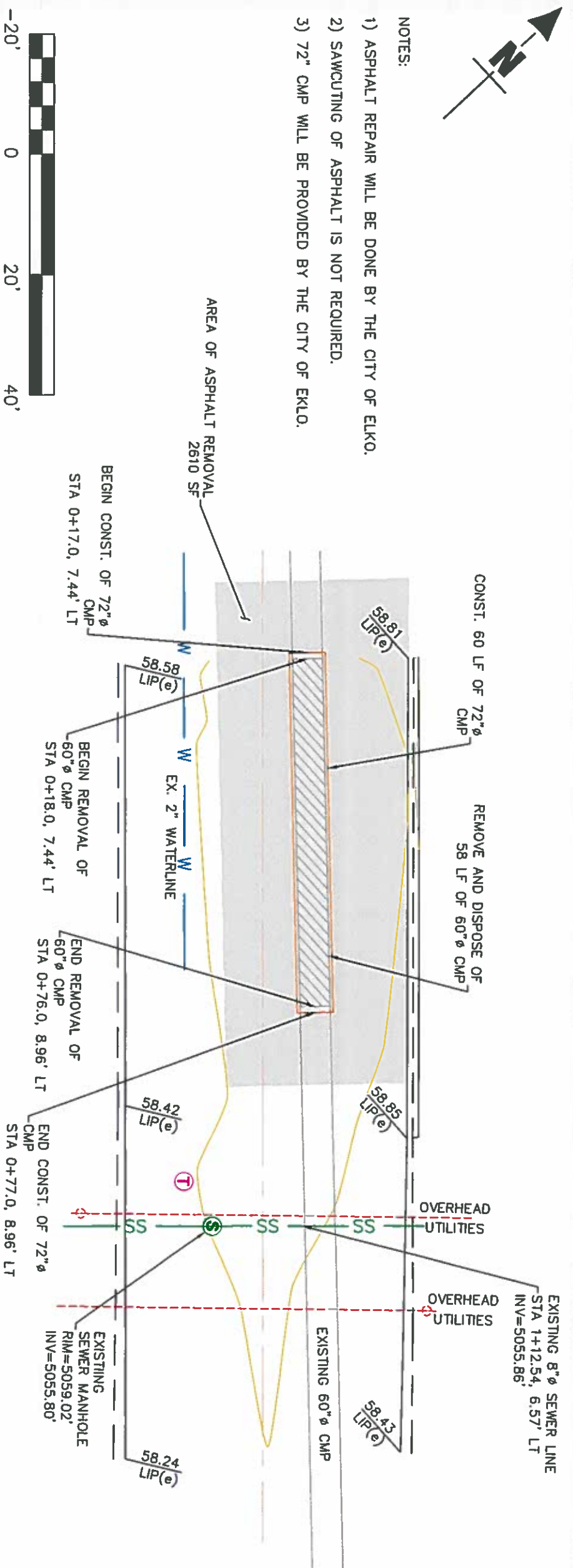

0+00

PROFILE

1+00

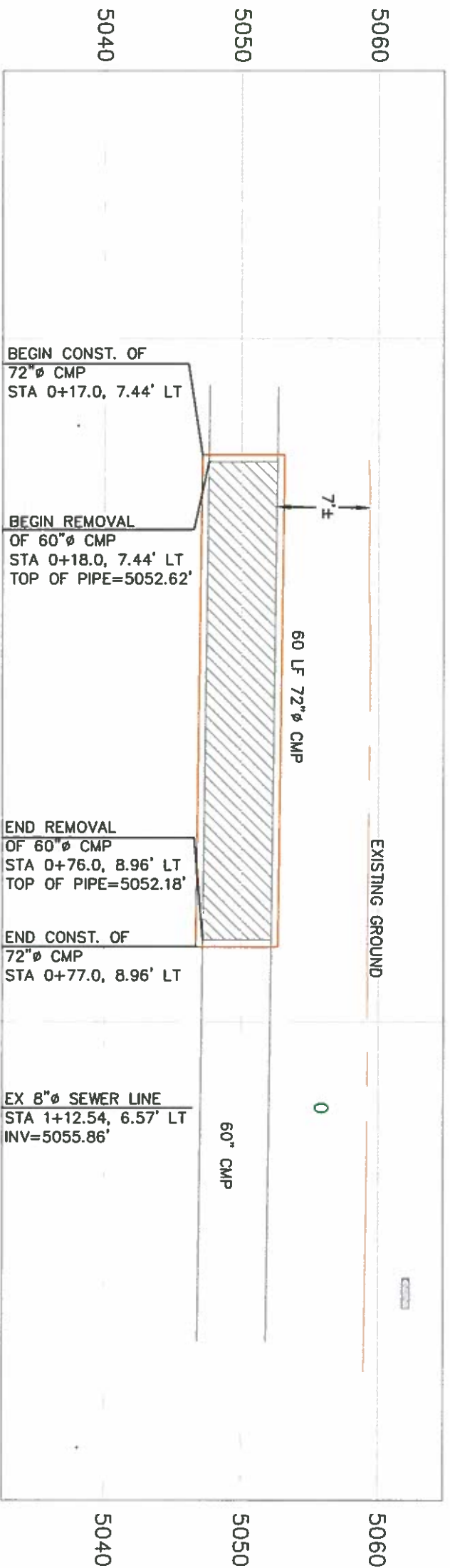

CITY OF ELKO  
1751 COLLEGE AVE  
ELKO, NEVADA 89801  
775-777-7210

SCALE

HORZ 1"=20'  
VERT 1"=10'

DESIGNED BY

JJ

DRAWN BY

ACAD 2017

CHECKED BY

BT

DATE

8/8/2017

CITY OF ELKO

6TH ST. STORM DRAIN REPAIR  
PLAN AND PROFILE



SHEET 2

OF 3

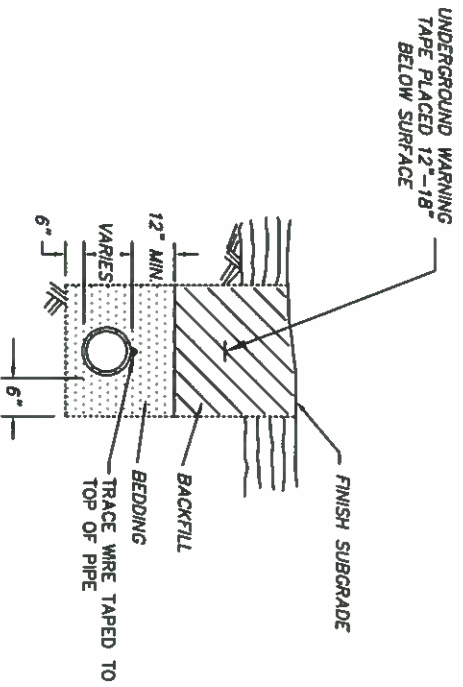

DUCTILE IRON PIPE, PVC, PE & HDPE PIPE

NOTES:

1. WATER DENSIFIED BACKFILL AND TUNNELING SHALL NOT BE ALLOWED.
2. BACKFILL SHALL MEET THE REQUIREMENTS FOR CLASS "E" BACKFILL WITH NO ROCKS SIZED OVER 4", COMPACTED IN 6" (MAX.) LIFTS TO 90% (MIN.) RELATIVE COMPACTION.
3. BEDDING MATERIAL FOR THE FOLLOWING PIPE SHALL MEET THE REQUIREMENTS OF SECTION 200 & 305 OF THE LATEST EDITION OF THE STANDARD SPECIFICATIONS FOR PUBLIC WORKS
  - A) DUCTILE IRON PIPE - CLASS "C"
  - B) ALL OTHER PIPE - CLASS "A"
4. FOR TRENCHES & EXCAVATIONS LOCATED WITHIN ROADWAY SECTION, SEE PAVEMENT PATCH DETAIL.
5. ALL TRENCHES AND EXCAVATIONS SHALL CONFORM TO THE LATEST EDITION OF O.S.H.A. AND M.U.T.C.D. REQUIREMENTS.
6. NATIVE MATERIAL MUST BE APPROVED BY THE CITY OF ELKO ENGINEER PRIOR TO USING AS BACKFILL OR BEDDING.
7. UNDERGROUND WARNING TAPE SHALL BE METALLIC AND APPROPRIATELY LABELED AND COLORED.

TRENCH EXCAVATION & BACKFILL

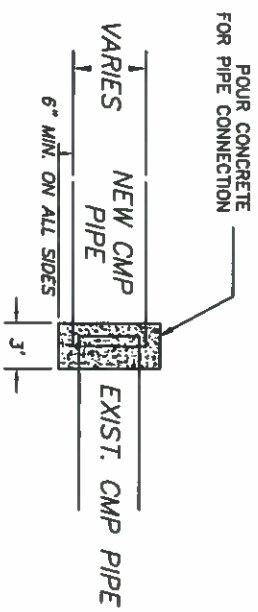

NOTES:

1. CONTRACTOR TO INSERT NEW PIPE INTO EXISTING PIPE A MINIMUM OF ONE FOOT.
2. CONCRETE ENCASE PIPE CONNECTION WITH MINIMUM 1.5' OVER EACH PIPE AND MINIMUM 6" THICK ON ALL SIDES.

CONCRETE PIPE CONNECTION



CITY OF ELKO  
1751 COLLEGE AVE  
ELKO, NEVADA 89801  
775-777-7210

SCALE

HORZ 1"=20'  
VERT none

DESIGNED BY

JJ

DRAWN BY

ACAD 2017

CHECKED BY

BT

DATE

8/8/2017

CITY OF ELKO

6TH ST. STORM DRAIN REPAIR  
DETAILS

SHEET 3

OF 3